

JAYCO
JAY COURTNEY COMPANY, INC
MADE IN THE USA



WWW.JAYCO.ORG



COMPLETE CATALOG



9412 NICHOLS ROAD • PO BOX 20026 • OKLAHOMA CITY, OK 73156
800-654-9263 • 405-751-6903 • FAX 405-755-7940 • WWW.JAYCO.ORG

TABLE OF CONTENTS

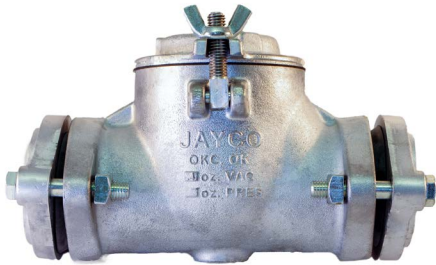

JAYCO VENT VALVE - PAGE 5



JAYCO THIEF HATCH - PAGE 12



JAYCO NON-VENT HATCH - PAGE 20

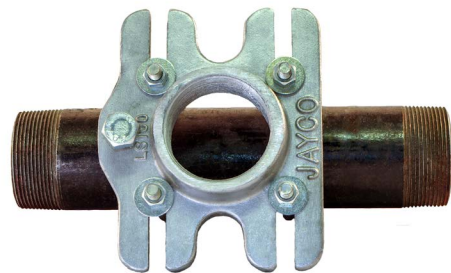

JAYCO LEVELING SADDLES - PAGE 22



WIKA MEASUREMENT TOOLS - PAGE 23

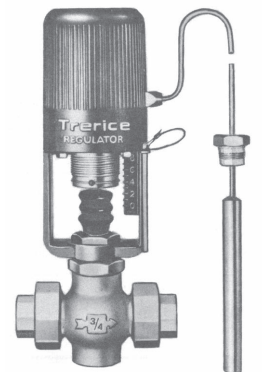

TRERICE REGULATORS - PAGE 27

TERMS AND CONDITIONS OF SALE AND RETURN POLICY

WARRANTY RETURNS

1. ONLY BRAND NEW MATERIAL, NEVER USED OR PLACED IN SERVICE, MAY BE REPLACED IMMEDIATELY. OTHERWISE, THE MATERIAL MUST BE RETURNED TO OKLAHOMA CITY TO BE SENT IN TO THE FACTORY FOR SERVICE. WARRANTY MERCHANDISE MUST BE RETURNED FREIGHT PREPAID TO OKLAHOMA CITY. IF THE MERCHANDISE IS DETERMINED TO BE COVERED UNDER WARRANTY, THE MERCHANDISE WILL BE REPAIRED OR REPLACED UNDER THE MANUFACTURERS WARRANTY TERMS, AND PREPAID FREIGHT TO THE CUSTOMER. WE SHALL NOT BE OBLIGATED TO REPAIR OR REPLACE MATERIAL WHICH HAS BEEN REPAIRED BY OTHERS, ABUSED, IMPROPERLY INSTALLED, ALTERED OR OTHERWISE MISUSED OR DAMAGED IN ANY WAY.

2. NO MATERIAL WILL BE ACCEPTED FOR RETURN CREDIT WITHOUT PRIOR PERMISSION, WHICH MUST BE REQUESTED WITHIN 6 MONTHS OF SHIPPING DATE OF MATERIAL. OTHERWISE, A 20% RESTOCKING CHARGE ON THE INVOICED PRICE WILL BE IN EFFECT. MERCHANDISE MUST HAVE PROOF OF PURCHASE (COPY OF INVOICE) FROM THE JAY COURTNEY COMPANY. NO RETURN ALLOWED ON "PRODUCT PROMOTION" OR OTHER SPECIAL PRICING, SPECIAL ORDER ITEMS, OR ON OBSOLETE PRODUCTS. RETURNED GOODS AND PACKAGING MUST BE IN NEW AND RESALABLE CONDITION, UNUSED, CURRENT DESIGN, FOR FULL CREDIT. NO REFUND ON FREIGHT CHARGES, AND FREIGHT MUST BE PREPAID BACK TO ORIGINAL SHIPPING POINT. IF FREIGHT WAS PAID BY JAY COURTNEY COMPANY IN ORIGINAL SHIPMENT, THAT FREIGHT WILL ALSO BE DEDUCTED FROM CREDIT ON RETURNED MERCHANDISE.

QUOTATION AND PRICING

3. WRITTEN QUOTES ARE GOOD FOR 30 DAYS, UNLESS OTHERWISE NOTED. AVAILABILITY OF ITEM(S) QUOTED IS SUBJECT TO PRIOR SALES. FORCE MAJEURE: ESTIMATED SHIPPING SCHEDULES ARE BASED UPON CONDITIONS PREVAILING AT THE DATES OF QUOTATIONS OR ACKNOWLEDGMENT OF ORDERS. JAY COURTNEY COMPANY SHALL NOT BE DEEMED TO BE IN DEFAULT OR LIABLE FOR ANY DELAY OR FAILURE OF PERFORMANCE HEREUNDER CAUSED BY FIRES, FLOODS OR OTHER ACTS OF GOD, STRIKES OR OTHER LABOR TROUBLES, GOVERNMENTAL ACTS OR RESTRICTIONS, OR OTHER UNFORESEEABLE CAUSES BEYOND THE REASONABLE CONTROL AND WITHOUT THE FAULT OR NEGLIGENCE OF JAY COURTNEY COMPANY.

4. STENOGRAPHIC, CLERICAL AND COMPUTER ERRORS, SUBJECT TO CORRECTION.

5. PRICES SHOWN ARE CURRENT PRICES. PRICES ARE SUBJECT TO CHANGE WITHOUT NOTICE. NON-STOCK ITEMS CANNOT BE CANCELED OR RETURNED.

6. ORDERS RECEIVED WITH A NET VALUE LESS THAN \$50 WILL BE SUBJECT TO A \$10 NET HANDLING CHARGE.

INCORRECT MERCHANDISE

7. ALL CLAIMS FOR SHORTAGES OR INCORRECT MERCHANDISE MUST BE REPORTED WITHIN SEVEN DAYS OF RECEIPT OF ORDER. NOTE: JAY COURTNEY COMPANY SHALL NOT CONSIDER MERCHANDISE SHIPPED AGAINST VERBAL, NON-CONFIRMED ORDERS AS QUALIFYING FOR INCORRECTLY SHIPPED MERCHANDISE RETURN.

8. WE RESERVE THE RIGHT TO SELL ONLY THRU ESTABLISHED STOCKING JOBBERS IN GOOD CREDIT STANDING.

9. IN NO EVENT SHALL WE BE LIABLE FOR INCIDENTAL OR CONSEQUENTIAL DAMAGES ARISING OUT OF OR FROM THE USE OF OUR PRODUCTS.
CLAIMS FOR SHORTAGES OR DAMAGES

CLAIMS FOR SHORTAGES OR DAMAGES

10. OUR RESPONSIBILITY CEASES UPON DELIVERY TO ANY COMMON CARRIER, AND WE DO NOT, UNLESS PREVIOUSLY INSTRUCTED, INSURE SHIPMENT BEYOND THE POINT OF DELIVERY TO SUCH CARRIER. ALL CLAIMS FOR SHORTAGES OR DAMAGES MUST BE LED WITH THE CARRIER.

PAYMENT TERMS

11. FOR CUSTOMERS WITH ESTABLISHED CREDIT TERMS: 1% 10 DAYS, NET 30 FROM SHIPMENT DATE.

12. IF CREDIT IS NOT ESTABLISHED, PAYMENT PLUS ESTIMATED FREIGHT CHARGES SHALL ACCOMPANY PURCHASE ORDER FOR NON-STANDARD PRODUCTS. FOR STANDARD PRODUCTS (O THE SHELF) JAY COURTNEY COMPANY WILL SHIP C.O.D. OR BY CREDIT CARD.

13. JAY COURTNEY COMPANY RESERVES THE RIGHT TO REVOKE ANY CREDIT EX- TENDED TO CUSTOMER IF CUSTOMER FAILS TO PAY FOR ANY SHIPMENTS WHEN DUE.

14. PAYMENT TERMS ARE SPECIFIED ON THE INVOICE. ANY INVOICE NOT PAID WHEN DUE IS SUBJECT TO A LATE PAYMENT CHARGE OF 1.5% PER MONTH, OR IF SUCH RATE IS GREATER THAN THE MAXIMUM RATE PERMITTED BY APPLICABLE LAW, THEN AT THE HIGHEST RATE ALLOWED BY APPLICABLE LAW.

15. IN THE EVENT THE BUYER FAILS TO MAKE FULL PAYMENT WHEN DUE AND JAY COURTNEY COMPANY EMPLOYS AN ATTORNEY OR COLLECTION AGENCY TO ASSIST IN COLLECTION OF THE ACCOUNT, BUYER AGREES TO PAY ALL OF JAY COURTNEY COMPANY'S REASONABLE COST OF COLLECTION INCLUDING COLLECTION AGENCY FEES, ATTORNEY FEES AND COURT COST.

BULLETIN NUMBER 1003

JAYCO VENT VALVES, INC.

LIMITED WARRANTY

A. ALL JAYCO PRODUCTS ARE WARRANTED AGAINST DEFECTS IN WORKMANSHIP OR MATERIALS UNDER NORMAL USE FOR ONE YEAR AFTER DATE OF PURCHASE FROM JAYCO UNLESS OTHERWISE STATED. (PROOF OF PURCHASE IS REQUIRED.) ANY PRODUCT WHICH IS DETERMINED BY JAYCO TO BE DEFECTIVE IN MATERIAL OR WORKMANSHIP AND RETURNED TO JAYCO, SHIPPING COST PREPAID, SHALL BE, AS THE SOLE REMEDY, REPAIRED, REPLACED OR CREDITED AT JAYCO'S OPTION.

B. THIS WARRANTY IS EXPRESSLY IN LIEU OF ALL OTHER WARRANTIES EXPRESSED OR IMPLIED, INCLUDING THE WARRANTIES OF MERCHANTABILITY AND FITNESS FOR USE AND OF ALL OTHER OBLIGATIONS OR LIABILITIES ON THE PART OF JAYCO, AND JAYCO NEITHER ASSUMES NOR AUTHORIZES ANY OTHER PERSON TO ASSUME FOR IT, ANY OTHER LIABILITY IN CONNECTION WITH THE SALE HEREUNDER. JAYCO DISCLAIMS ANY LIABILITY FOR PRODUCT DEFECTS THAT ARE DUE TO PRODUCT MISUSE, IMPROPER PRODUCT SELECTION OR MISAPPLICATION.

C. JAYCO SHALL NOT BE LIABLE FOR CUSTOMER'S COST, LOST PROFITS, GOOD WILL OR OTHER SPECIAL OR CONSEQUENTIAL DAMAGES. JAYCO'S LIABILITY IN ALL EVENTS IS LIMITED TO, AND SHALL NOT EXCEED, THE VALUE OF MERCHANDISE INVOLVED.

D. REMEDIES – ANY CONTROVERSY OR CLAIM ARISING OUT OF OR RELATING TO THIS CONTRACT, OR THE BREACH THEREOF, SHALL BE SETTLED BY ARBITRATION IN OKLAHOMA COUNTY, STATE OF OKLAHOMA IN ACCORDANCE WITH THE COMMERCIAL ARBITRATION RULES OF THE AMERICAN ARBITRATION ASSOCIATION, AND JUDGMENT ON THE AWARD RENDERED BY THE ARBITRATOR(S) MAY BE ENTERED IN A COURT HAVING JURISDICTION THERE.

E. RECOMMENDATIONS FOR USING JAYCO PRODUCTS ARE BELIEVED TO BE RELIABLE. HOWEVER, SINCE THE APPLICATION OF THESE ITEMS IS BEYOND OUR CONTROL, NO GUARANTEE, EXPRESSED OR IMPLIED, IS MADE ON THEIR USE, HANDLING, POSSESSION OR RESULTS.



THE PURPOSE OF THE VENT VALVE IS TO WORK IN TANDEM WITH THE THIEF HATCH TO MINIMIZE THE ESCAPE OF LIGHT ENDS OF CRUDE IN LEASE STORAGE BY MAINTAINING A PRESSURE ON THE TANK. A VACUUM RELIEF FUNCTION IS ALSO STANDARD WITH OPTIONS TO CLOSE OFF FOR PREASURE ONLY. SLIP ON FLANGES AT EACH END ALLOWS FOR CONNECTION TO THE HORIZONTAL PIPE RUN. THE VALVE BODIES ARE ENGINEERED TO HAVE LOW IMPACT ON THE FLOW OF MEDIA THROUGH THE PIPE RUN.

JAYCO INLINE VENT VALVES ARE DESIGNED FOR OPTIMUM PERFORMANCE AND EASY CLEAN OUT AND MAINTENANCE, AND ARE AVAILABLE IN 2, 3, AND 4 INCH SLIP-ON ENDS WITH STANDARD SETTINGS OF 1.5 OUNCE PRESSURE AND 0.4 OUNCE VACUUM WITH ADDITIONAL WEIGHTS AVAILABLE IN ONE OUNCE INCREMENTS. JAYCO VALVES COME STANDARD WITH BUNA N GASKETS DESIGNED TO WORK IN NORMAL (SWEET CRUDE) OPERATION OF TANK SYSTEMS IN THE OILFIELD.

INLINE SPECIFICATIONS

CONSTRUCTION:	ALL ALUMINUM CASTINGS
SYSTEM OPERATIONS:	WEIGHTED PRESSURE SPRING LOADED VACUUM
STANDARD SETTINGS:	1.5 oz. PRESSURE 0.4 oz. VACUUM
OPTIONAL SETTINGS:	1 oz. INCREMENTS UP TO 16 oz. PRESSURE ONLY VALVE
GASKET MATERIAL:	SUPREME65 OR BLACK VITON®
2 INCH:	JV 101
3 INCH:	JV 301
4 INCH:	JV 500



VITON® IS A REGISTERED TRADEMARK OF DUPONT DOW ELASTOMERS

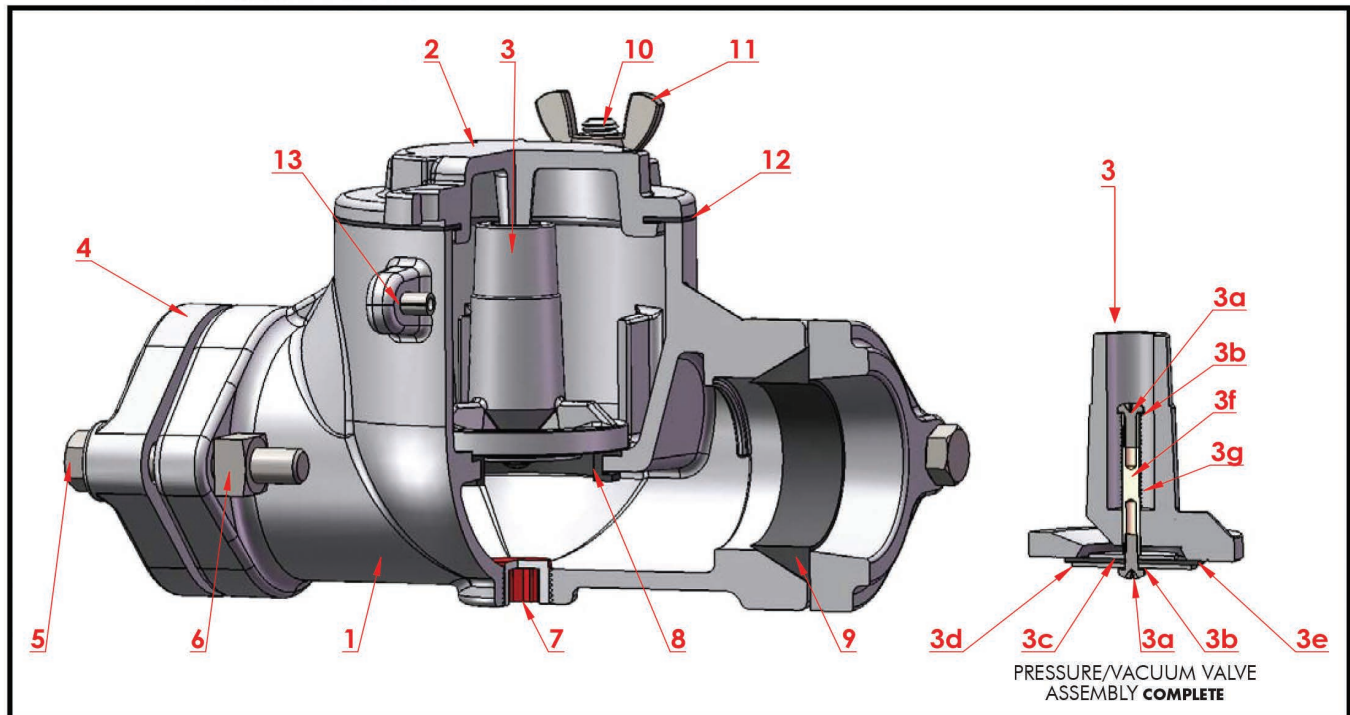

	JV 101 - 2"	JV 301 - 3"	JV 500 - 4"
BODY LENGTH W/O FLANGES HEIGHT	8.25"L 7"H	10"L 8"H	10.5"L 10.5"H
1. VALVE BODY - ALUMINUM			
2. VALVE BODY CAP - ALUMINUM	JV0121	JV0321A	JV0520
3. PRESSURE/VACUUM VALVE ASSEMBLY <i>COMPLETE</i>	JV0110	JV0311	JV0510
3a. PAN HEAD SCREW - ZINC PLATED	JV0156	JV0156	JV0156
3b. INTERNAL LOCK WASHER - ZINC PLATED	JV0155	JV0155	JV0155
3c. WASHER (SMALL) - ALUMINUM	JV0148	JV0150	JV0348
3d. WASHER (LARGE) - ALUMINUM	JV0150	JV0348	JV0350
** 3e. VACUUM GASKET - BUNA N	JV0152	JV0353	JV0352
VACUUM GASKET (SOUR SERVICE) - VITON®	JV0153	JV0354	JV0553
3f. VACUUM VALVE STEM - BRASS	JV0146	JV0146	JV0446
** 3g. VACUUM SPRING - STAINLESS STEEL	JV0144	JV0144	JV0444
4. SLIP-ON FLANGE - ALUMINUM	JV0136	JV0337	JV0436
5. SLIP-ON FLANGE BOLT - ZINC PLATED	JV0181	JV0181	JV0181
6. SLIP-ON FLANGE NUT - ZINC PLATED	JV0180	JV0180	JV0180
7. DRAIN PLUG - RED PLASTIC	JV0158	JV0158	JV0158
** 8. PRESSURE O-RING GASKET - VITON® <i>CURRENT VALVES</i>	JV0141	JV0341	JV0440
PRESSURE CLIP-IN GASKET - BUNA N <i>ORIGINAL VALVES</i>	JV0142	JV0343	JV0342
9. SLIP-ON FLANGE GASKET - BUNA N	JV0134	JV0335	JV0434
10. EYE BOLT - ALUMINUM	JV0126	JV0126	JV0126
11. HEX NUT - ZINC PLATED <i>REPLACES WING NUT</i>	JV0137	JV0137	JV0137
** 12. CAP GASKET - BUNA N	JV0125	JV0323	JV0522
CAP GASKET (SOUR SERVICE) - VITON®	JV0127	JV0325	JV0523
13. GROOVE PIN - ZINC PLATED	JV0131	JV0130	JV0130
PRESSURE WEIGHT 1.0 oz - BRONZE	JV0260B	JV0360B	JV0460B
PRESSURE WEIGHT 0.5 oz - BRONZE	JV0260A	JV0360A	JV0460A

HIGHER WEIGHT SETTINGS VISIT: WWW.JAYCO.ORG/PRODUCTS-CATEGORY/JAYCO-VENT-VALVE/

IN KEEPING WITH, AND FOR THE PURPOSE OF PRODUCT IMPROVEMENT, JAYCO RESERVES THE RIGHT TO MAKE DESIGN CHANGES WITHOUT PRIOR NOTICE.

** REPAIR KIT

VITON® IS A REGISTERED TRADEMARK OF DUPONT DOW ELASTOMERS

BULLETIN NUMBER 1015 23



THE PURPOSE OF THE VENT VALVE IS TO WORK IN TANDEM WITH THE THIEF HATCH TO MINIMIZE THE ESCAPE OF LIGHT ENDS OF CRUDE IN LEASE STORAGE BY MAINTAINING A PRESSURE ON THE TANK. STACK VALVES INSTALL ATOP A VERTICAL PIPE. PRESSURE FROM THE VESSEL IS VENTED TO ATMOSPHERE WHILE A VACUUM ON THE VESSEL DRAWS OUTSIDE AIR THROUGH THE VALVE. OPTIONAL VENTING LEVERS ARE AVAILABLE FOR MANUAL VENTING. THE VALVE BODIES ARE ENGINEERED TO HAVE LOW IMPACT ON THE FLOW OF MEDIA THROUGH THE PIPE RUN.

JAYCO STACK VENT VALVES ARE DESIGNED FOR OPTIMUM PERFORMANCE AND EASY CLEAN OUT AND MAINTENANCE, AND ARE AVAILABLE IN 2, 3, AND 4 INCH SLIP-ON ENDS WITH STANDARD SETTINGS OF 1.5 OUNCE PRESSURE AND 0.4 OUNCE VACUUM WITH ADDITIONAL WEIGHTS AVAILABLE IN ONE OUNCE INCREMENTS. JAYCO VALVES COME STANDARD WITH BUNA N GASKETS DESIGNED TO WORK IN NORMAL (SWEET CRUDE) OPERATION OF TANK SYSTEMS IN THE OILFIELD.

INLINE SPECIFICATIONS

CONSTRUCTION:	ALL ALUMINUM CASTINGS
SYSTEM OPERATIONS:	WEIGHTED PRESSURE SPRING LOADED VACUUM
STANDARD SETTINGS:	1.5 oz. PRESSURE 0.4 oz. VACUUM
OPTIONAL SETTINGS:	1 oz. INCREMENTS UP TO 16 oz. PRESSURE ONLY VALVE
GASKET MATERIAL:	SUPREME65 OR BLACK VITON®
2 INCH:	JV 200
3 INCH:	JV 401
4 INCH:	JV 600



VITON® IS A REGISTERED TRADEMARK OF DUPONT DOW ELASTOMERS

9412 NICHOLS ROAD • PO BOX 20026 • OKLAHOMA CITY, OK 73156

800-654-9263 • 405-751-6903 • FAX 405-755-7940 • WWW.JAYCO.ORG

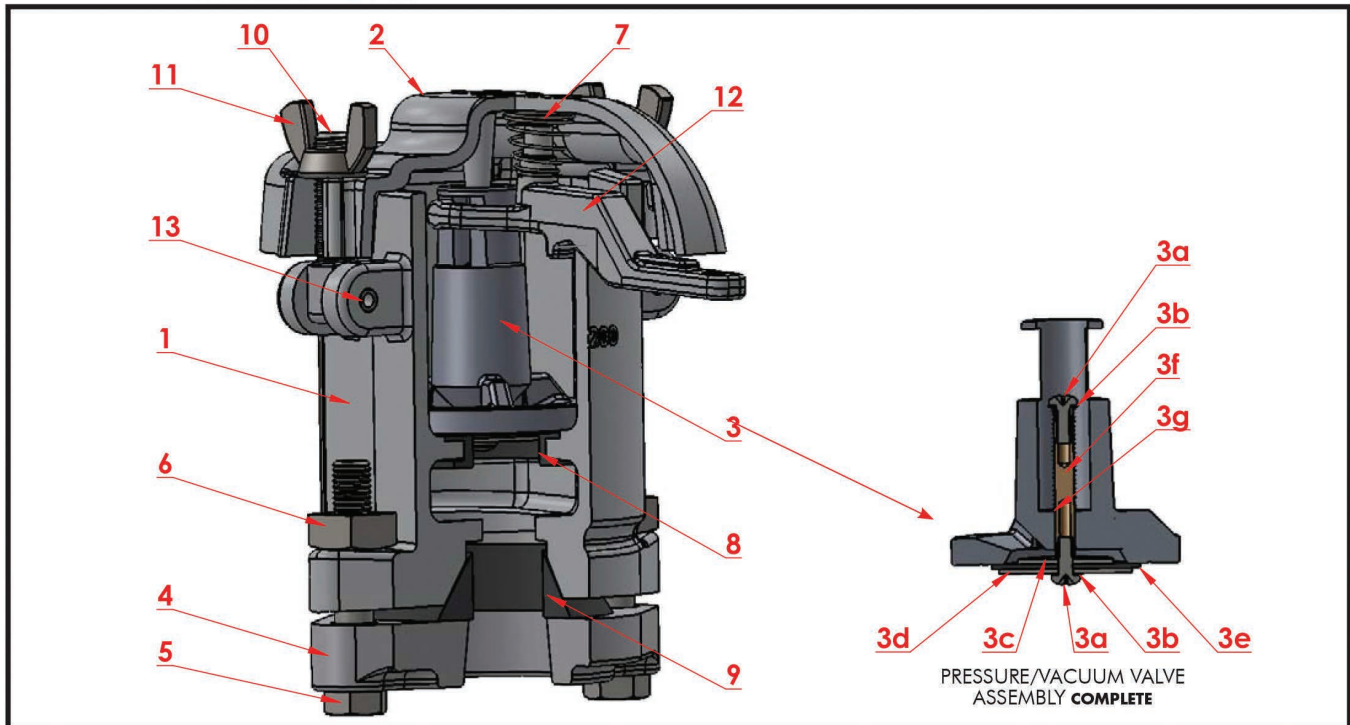

	JV 200 - 2"	JV 401 - 3"	JV 600 - 4"
1. VALVE BODY - ALUMINUM			
2. VALVE BODY CAP - ALUMINUM	JV0220	JV0421	JV0420
3. PRESSURE/VACUUM VALVE ASSEMBLY <i>COMPLETE</i>	JV0110	JV0311	JV0510
3a. PAN HEAD SCREW - ZINC PLATED	JV0156	JV0156	JV0156
3b. INTERNAL LOCK WASHER - ZINC PLATED	JV0155	JV0155	JV0155
3c. WASHER (SMALL) - ALUMINUM	JV0148	JV0150	JV0348
3d. WASHER (LARGE) - ALUMINUM	JV0150	JV0348	JV0350
** 3e. VACUUM GASKET - BUNA N	JV0152	JV0353	JV0352
VACUUM GASKET (SOUR SERVICE) - VITON®	JV0153	JV0354	JV0553
3f. VACUUM VALVE STEM - BRASS	JV0146	JV0146	JV0446
** 3g. VACUUM SPRING - STAINLESS STEEL	JV0144	JV0144	JV0444
4. SLIP-ON FLANGE - ALUMINUM	JV0136	JV0337	JV0436
5. SLIP-ON FLANGE BOLT - ZINC PLATED	JV0181	JV0181	JV0181
6. SLIP-ON FLANGE NUT - ZINC PLATED	JV0180	JV0180	JV0180
7. CONICAL LEVER SPRING - ZINC PLATED <i>OPTIONAL</i>	JV0262	JV0262	JV0262
** 8. PRESSURE O-RING GASKET - VITON® <i>CURRENT VALVES</i>	JV0141	JV0341	JV0440
PRESSURE CLIP-IN GASKET - BUNA N <i>ORIGINAL VALVES</i>	JV0142	JV0343	JV0342
9. SLIP-ON FLANGE GASKET - BUNA N	JV0134	JV0335	JV0434
10. EYE BOLT - ALUMINUM	JV0126	JV0126	JV0126
11. HEX NUT - ZINC PLATED <i>REPLACES WING NUT</i>	JV0137	JV0137	JV0137
12. LEVER - ALUMINUM <i>OPTIONAL</i>	JV0230	JV0431	JV0431
13. GROOVE PIN - ZINC PLATED	JV0131	JV0130	JV0130
PRESSURE WEIGHT 1.0 oz - BRONZE	JV0260B	JV0360B	JV0460B
PRESSURE WEIGHT 0.5 oz - BRONZE	JV0260A	JV0360A	JV0460A
LEVER ROLL PIN - ZINC PLATED <i>DISCONTINUED</i>	JV0264	JV0264	JV0264

HIGHER WEIGHT SETTINGS VISIT: WWW.JAYCO.ORG/PRODUCTS-CATEGORY/JAYCO-VENT-VALVE/

IN KEEPING WITH, AND FOR THE PURPOSE OF PRODUCT IMPROVEMENT, JAYCO RESERVES THE RIGHT TO MAKE DESIGN CHANGES WITHOUT PRIOR NOTICE.

** REPAIR KIT

VITON® IS A REGISTERED TRADEMARK OF DUPONT DOW ELASTOMERS

BULLETIN NUMBER 1007 23

JAYCO VENT VALVES ARE SHIPPED FROM THE FACTORY SET AT 1.3 OZ/INCH² PRESSURE FOR 2" AND 3" VALVES WHILE 4" VALVES ARE SET AT 1.5 OZ/INCH², UNLESS OTHERWISE SPECIFIED. THE VACUUM SETTING OF 0.4 OZ/INCH² IS SPRING OPERATED AND NOT AFFECTED BY CHANGING THE PRESSURE SETTING.

TO INCREASE THE PRESSURE SETTING OF THE VALVE, WEIGHTS CAN BE ADDED TO THE INTERNAL PLUNGER ASSEMBLY. FOR HIGHER PRESSURE SETTINGS THE ALUMINUM PLUNGER MUST BE REPLACED BY A BULLET PLUNGER.



SMALL INCREASE

ADD WEIGHT(S) IN 0.5 OZ/INCH² OR 1 OZ/INCH² INCREMENTS TO THE PLUNGER ASSEMBLY TO GAIN DESIRED PRESSURE SETTING. THIS IS DONE WITH BRONZE WASHERS CALLED WEIGHTS. EACH VALVE HAS A MAXIMUM AMOUNT OF WASHERS THAT CAN BE ADDED.

PICTURED 1 oz WEIGHT • FLEXIBILITY

MEDIUM INCREASE

WHEN ADDING MORE THAN 1 OZ/INCH² A CUSTOM BRONZE WEIGHT CAN BE ADDED TO THE PLUNGER ASSEMBLY TO GAIN THE DESIRED PRESSURE SETTING. I.E. ADD A 2.5 OZ/INCH² WEIGHT TO A STANDARD PLUNGER ASSEMBLY TO HAVE A PRESSURE SETTING OF 4 OZ/INCH², (1.5 + 2.5 = 4.0).

PICTURED 2.5 oz WEIGHT • ECONOMICAL



LARGE INCREASE

FOR HIGHER PRESSURE SETTINGS THE PLUNGER ASSEMBLY MUST BE SWITCHED OUT WITH A CUSTOM "BULLET PLUNGER ASSEMBLY." THESE LARGE BRONZE WEIGHTS HAVE THE VACUUM BREAKER BUILT INTO THEM. THESE ARE SOLD BY THEIR TOTAL PRESSURE SETTING AND NOT THEIR ADDITIONAL INCREASE LIKE THE WEIGHTS.

PICTURED 16 oz BULLET PLUNGER

THE FOLLOWING PAGES HAVE THE PART NUMBERS TO ASSIST YOU IN ORDERING WEIGHTS FOR THE SIX JAYCO VENT VALVES. ON THESE PAGES YOU CAN SEE THE MAXIMUM AMOUNT OF WEIGHTS THAT CAN BE ADDED TO EACH VALVE AND WHEN A "BULLET PLUNGER" MUST BE USED.

REMEMBER THAT INCREASING THE PRESSURE SETTING ON THE VENT VALVE WILL DELAY THE PRESSURE RELIEF. MAKE SURE THAT THE CHANGES MADE WILL WORK WITHIN THE CONFINES OF THE INSTALLATION. PLEASE CALL IF YOU HAVE QUESTIONS ABOUT THIS DOCUMENT.

JAYCO VENT VALVES WEIGHTS 2" JV101 & JV200

PRESSURE SETTING	ADDITIONAL WEIGHT	WEIGHT P/N	BULLET PLUNGER P/N
1.3 oz	STANDARD	--	--
2.0 oz	0.7 oz	JV0260Z	--
2.5 oz	0.5 & .7 oz	JV0260A + JV0260Z	--
3.0 oz	1.0 & .7 oz	JV0260B + JV0260Z	--
3.5 oz	1.5 & .7 oz	JV0260C + JV0260Z	--
4.0 oz	2.0 & .7 oz	JV0260D + JV0260Z	--
4.5 oz	2.5 & .7 oz	JV0260E + JV0260Z	--
5.0 oz	3.0 & .7 oz	JV0260F + JV0260Z	--
5.5 oz	3.5 & .7 oz	JV0260G + JV0260Z	--
6.0 oz	4.0 & .7 oz	JV0260H + JV0260Z	--
6.5 oz	4.5 & .7 oz	JV0260I + JV0260Z	--
7.0 oz	5.0 & .7 oz	JV0260J + JV0260Z	←
* 7.5 oz	5.5 & .7 oz	JV0260K + JV0260Z	--
* 8.0 oz	6.0 & .7 oz	JV0260L + JV0260Z	--
* 8.5 oz	6.5 & .7 oz	JV0260M + JV0260Z	--
* 9.0 oz	7.0 & .7 oz	JV0260N + JV0260Z	--
* 10.0 oz	--	--	JV0261A
* 12.0 oz	--	--	JV0261B
* 14.0 oz	--	--	JV0261E
* 16.0 oz	--	--	JV0261G

MAX AMOUNT OF STACKED 1 oz WASHERS

- ALL WEIGHTS LISTED ABOVE ARE IN OZ/INCH²
- MAX AMOUNT OF STACKED 1 OZ WEIGHTS IS 5 FOR A PRESSURE SETTING OF 6.5 oz
- CUSTOM BRONZE WEIGHTS RANGE FROM 1.5 oz TO 7.5 oz (3 oz TO 9 oz PRESSURE SETTINGS)
- PRESSURE SETTINGS FROM 10 oz TO 16 oz REQUIRE A "BULLET PLUNGER" INSTEAD OF ADDING WEIGHTS TO THE EXISTING PLUNGER. BULLET PLUNGERS REPLACE THE ORIGINAL PLUNGER AND CANNOT HAVE ADDITIONAL WEIGHT ADDED TO THEM
- WHEN MIXING WEIGHTS, INSTALL THE BIGGER (HEAVIER) WEIGHT ON TOP OF THE SMALLER WEIGHT
- * ON THE JV200, THE BLEEDER LEVER AND THE CONICAL LEVER SPRING MUST BE REMOVED WHEN THE PRESSURE SETTING IS SET BETWEEN 7.5 oz & 16 oz (P/N'S JV0230 & JV0262)

JAYCO VENT VALVES WEIGHTS 3" JV301 & JV401

PRESSURE SETTING	ADDITIONAL WEIGHT	WEIGHT P/N	BULLET PLUNGER P/N
1.3 oz	STANDARD	--	--
2.0 oz	0.7 oz	JV0360Z	--
2.5 oz	0.5 & .7 oz	JV0360A + JV0360Z	--
3.0 oz	1.0 & .7 oz	JV0360B + JV0360Z	--
3.5 oz	1.5 & .7 oz	JV0360C + JV0360Z	--
4.0 oz	2.0 & .7 oz	JV0360D + JV0360Z	--
4.5 oz	2.5 & .7 oz	JV0360E + JV0360Z	--
* 5.0 oz	3.0 & .7 oz	JV0360F + JV0360Z	←
* 5.5 oz	3.5 & .7 oz	JV0360G + JV0360Z	--
* 6.0 oz	4.0 & .7 oz	JV0360H + JV0360Z	--
* 6.5 oz	4.5 & .7 oz	JV0360I + JV0360Z	--
* 7.0 oz	5.0 & .7 oz	JV0360J + JV0360Z	--
* 7.5 oz	5.5 & .7 oz	JV0360K + JV0360Z	--
* 8.0 oz	6.0 & .7 oz	JV0360L + JV0360Z	--
* 9.0 oz	--	--	JV0361B
* 10.0 oz	--	--	JV0361C
* 12.0 oz	--	--	JV0361D
* 14.0 oz	--	--	JV0361E
* 16.0 oz	--	--	JV0361F

MAX AMOUNT OF STACKED 1 oz WASHERS

- ALL WEIGHTS LISTED ABOVE ARE IN OZ/INCH²
- MAX AMOUNT OF STACKED 1 oz WEIGHTS IS 4 FOR A PRESSURE SETTING OF 5.5 oz
- CUSTOM BRONZE WEIGHTS RANGE FROM 1.5 oz TO 6 oz (3 oz TO 7.5 oz PRESSURE SETTINGS)
- A MODIFIED PLUNGER MUST BE USED WITH 4.5 oz TO 6.5 oz WEIGHTS. THE MODIFIED PLUNGER ALLOWS FOR MORE SPACE TO FIT THE HEAVIER CUSTOM WEIGHTS. P/N IS JV0311 (STARTING IN 2013, NEW VALVES ARE SHIPPING WITH MODIFIED PLUNGERS)
- PRESSURE SETTINGS FROM 9 oz TO 12 oz REQUIRE A "BULLET PLUNGER" INSTEAD OF ADDING WEIGHTS TO THE EXISTING PLUNGER. BULLET PLUNGERS REPLACE THE ORIGINAL PLUNGER AND CANNOT HAVE ADDITIONAL WEIGHT ADDED TO THEM
- WHEN MIXING WEIGHTS, INSTALL THE BIGGER (HEAVIER) WEIGHT ON TOP OF THE SMALLER WEIGHT
- * ON THE JV 401, THE BLEEDER LEVER AND THE CONICAL LEVER SPRING MUST BE REMOVED WHEN THE PRESSURE SETTING IS SET BETWEEN 5 oz & 12 oz (P/N'S JV0430 & JV0262)

JAYCO VENT VALVES WEIGHTS

4" JV500 & JV600

PRESSURE SETTING	ADDITIONAL WEIGHT	WEIGHT P/N	BULLET PLUNGER P/N
1.5 oz	STANDARD	--	--
2.0 oz	0.5oz	JV0460A	--
2.5 oz	1.0 oz	JV0460B	--
3.0 oz	1.5oz	JV0460C	--
3.5 oz	2.0 oz	JV0460D	--
4.0 oz	2.5oz	JV0460E	--
4.5 oz	3.0 oz	JV0460F	--
5.0 oz	3.5oz	JV0460G	--
5.5 oz	4.0 oz	JV0460H	--
6.0 oz	4.5 oz	JV0460I	--
6.5 oz	5.0 oz	JV0460J	--
7.0 oz	5.5oz	JV0460K	--
7.5 oz	6.0 oz	JV0460L	--
8.0 oz	6.5oz	JV0460M	--
8.5 oz	7.0 oz	JV0460N	--
9.0 oz	7.5oz	JV0460O	--
* 9.5 oz	8.0 oz	JV0460P	--
* 10.0 oz	8.5 oz	JV0460Q	--
* 10.5 oz	9.0 oz	JV0460R	--
* 11.0 oz	9.5 oz	JV0460S	--
* 11.5 oz	10 oz	JV0460T	--
* 12.0 oz	10.5 oz	JV0460U	--
* 14.0 oz	--	--	JV0461A
* 16.0 oz	--	--	JV0461B

MAX AMOUNT
OF STACKED 1 oz
WASHERS

- ALL WEIGHTS LISTED ABOVE ARE IN OZ/INCH²
 - MAX AMOUNT OF STACKED 1 oz WEIGHTS IS 7 FOR A PRESSURE SETTING OF 8.5 oz
 - CUSTOM BRONZE WEIGHTS RANGE FROM 1.5 oz TO 10.5oz (3oz TO 12oz PRESSURE SETTINGS)
 - PRESSURE SETTINGS FROM 14 oz TO 16 oz REQUIRE A "BULLET PLUNGER" INSTEAD OF ADDING WEIGHTS TO THE EXISTING PLUNGER. BULLET PLUNGERS REPLACE THE ORIGINAL PLUNGER AND CANNOT HAVE ADDITIONAL WEIGHT ADDED TO THEM
 - WHEN MIXING WEIGHTS, INSTALL THE BIGGER (HEAVIER) WEIGHT ON TOP OF THE SMALLER WEIGHT
- * ON THE JV600, THE BLEEDER LEVER AND THE CONICAL LEVER SPRING MUST BE REMOVED WHEN THE PRESSURE SETTING IS SET BETWEEN 9.5 oz & 16 oz (P/N'S JV0430 & JV0262)



THE PURPOSE OF THE THIEF HATCH IS TO WORK IN TANDEM WITH THE VENT VALVE TO MINIMIZE THE ESCAPE OF LIGHT ENDS OF CRUDE IN LEASE STORAGE BY MAINTAINING A PRESSURE ON THE TANK. A VACUUM RELIEF FUNCTION IS ALSO STANDARD. THE THIEF HATCH PERMITS ACCESS TO THE CONTENTS OF THE TANK FOR SAMPLING AND GAUGING. THE VENT VALVE SHOULD BE SET TO VENT PRESSURE BEFORE THE THIEF HATCH.

JAYCO THIEF HATCHES ARE DESIGNED FOR OPTIMUM PERFORMANCE AND EASY CLEANING AND MAINTENANCE, WITH STANDARD SETTINGS OF 4.0 OUNCE PRESSURE AND 0.4 OUNCE VACUUM WITH OPTIONAL SPRINGS FOR 2, 6, 8, 12, 14, AND 16 OUNCE PRESSURE SETTINGS. JAYCO THIEF HATCHES ALLOWS LESS THAN 1.0 CFH @ 90% OF SET PRESSURE. BASE GASKET STANDARD WITH HATCH.

JT-8.1 SPECIFICATIONS

BASE AND LID SIZE:	NOMINAL 8" ROUND
BOLT PATTERN:	16 HOLES AT 10 3/8" CIRCLE (API) (RECOMMENDED TORQUE 16-18 FT-LBS)
CONSTRUCTION:	ALL ALUMINUM CASTINGS
SYSTEM OPERATIONS:	SPRING LOADED PRESSURE AND VACUUM
STANDARD SETTINGS:	4 OZ. PRESSURE 0.4 OZ. VACUUM
GASKET MATERIAL:	SUPREME65, BLACK VITON® OR BLUE VITON®
BASE GASKET:	INCLUDED

APPROXIMATE SHIPPING WEIGHT: 14 LBS • VITON® IS A REGISTERED TRADEMARK OF DUPONT DOW ELASTOMERS

PRESSURE SPRINGS



9412 NICHOLS ROAD • PO BOX 20026 • OKLAHOMA CITY, OK 73156

800-654-9263 • 405-751-6903 • FAX 405-755-7940 • WWW.JAYCO.ORG

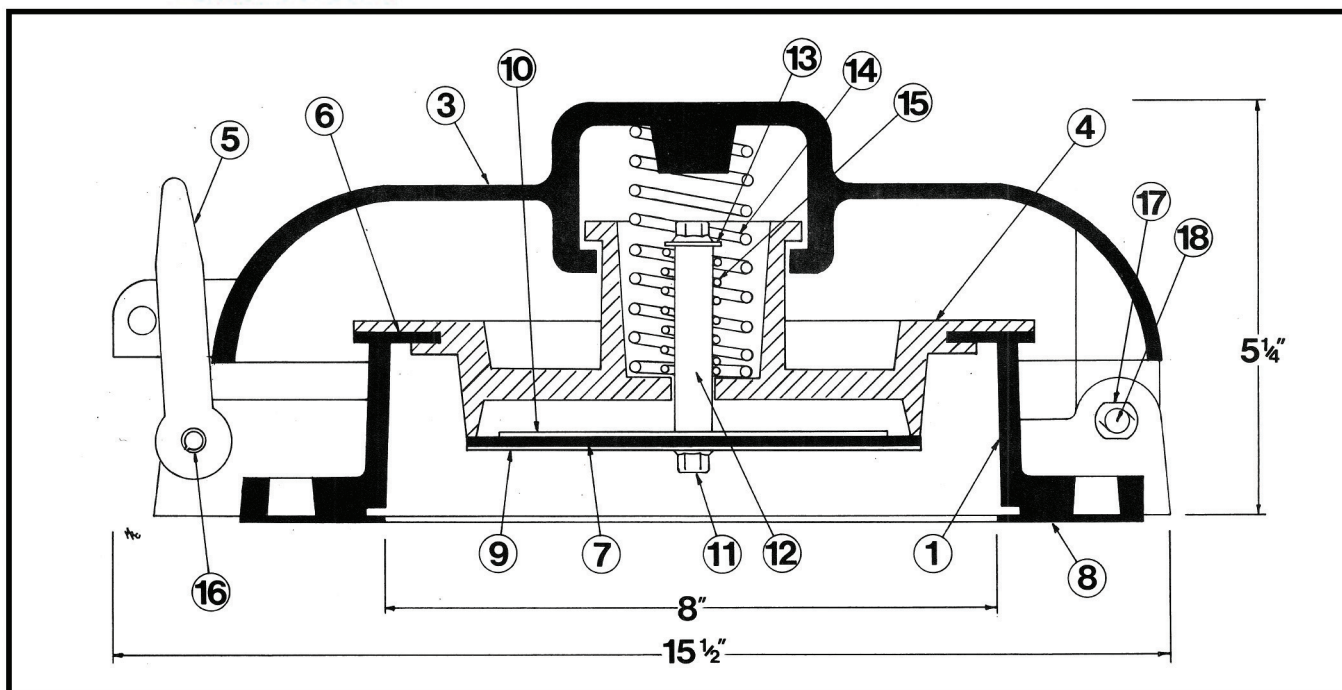

1. BASE (RECOMMENDED TORQUE 16-18 FT-LBS)	JT8172	ALUMINUM
3. LID	JT18176	ALUMINUM
4. PRESSURE/VACUUM VALVE COMPLETE (INCLUDES **)	JT1818S	ALUMINUM
5. LATCH	JT8205	ALUMINUM
**6 & 7. PRESSURE & VACUUM GASKET SET (JT1815S & JT1820S)	JT1SUPR652P	SUPREME65
PRESSURE & VACUUM SOUR SERV. SET (JT1815V & JT1820V)	JT1VITON2P	VITON®
PRESSURE & VACUUM BLUE WRAP SET (JT1815WV & JT1820WV)	JT1VITONW	VITON®
8. BASE GASKET	JT1810S	SUPREME65
BASE GASKET (SOUR SERVICE)	JT1810V	VITON®
** 9. WASHER (LOWER)	JT0863	ALUMINUM
** 10. WASHER (UPPER)	JT0860	ALUMINUM
** 11. SCREW HHTL 1/4-20 X 3/4	JT0871	STAINLESS
** 12. STEM 1/2 X 2 1/2	JT0850	ALUMINUM
** 13. WASHER 1/4	JT0861	STAINLESS
14. SPRING, PRESSURE (STANDARD 4 oz PLATED)		
4 oz (PLAIN) JT0835	2 oz (BLACK) JT0830	PLATED OR SS
6 oz (YELLOW) JT0837	8 oz (ORANGE) JT0838	STAINLESS
12 oz (WHITE) JT0846	14 oz (GREEN) JT0839	STAINLESS
16 oz (BLUE) JT0847	24 oz (PURPLE) JT0849	STAINLESS
** 15. SPRING, VACUUM	JT0825	STAINLESS
16. LATCH ROLL PIN	JV0130	ZINC PLATED
17. PUSH NUT, 1/4 (USE ONLY ONCE - THEN REPLACE)	JT0887	
18. HINGE PIN (SHORT)	JT0875	GALVANIZED
** WASHER, INTERNAL LOCK, BOTTOM	JT0872	STAINLESS
MOUNTING BOLT AND NUT SET (16)	JT-B&N	ZINC PLATED

IN KEEPING WITH, AND FOR THE PURPOSE OF PRODUCT IMPROVEMENT, JAYCO RESERVES THE RIGHT TO MAKE DESIGN CHANGES WITHOUT PRIOR NOTICE.

** PRESSURE/VACUUM VALVE INCLUDES THESE PARTS PLUS MORE UNSHOWN PARTS

BULLETIN NUMBER 1015 23

VITON® IS A REGISTERED TRADEMARK OF DUPONT DOW ELASTOMERS



THE PURPOSE OF THE THIEF HATCH IS TO WORK IN TANDEM WITH THE VENT VALVE TO MINIMIZE THE ESCAPE OF LIGHT ENDS OF CRUDE IN LEASE STORAGE BY MAINTAINING A PRESSURE ON THE TANK. A VACUUM RELIEF FUNCTION IS ALSO STANDARD. THE THIEF HATCH PERMITS ACCESS TO THE CONTENTS OF THE TANK FOR SAMPLING AND GAUGING. THE JT-20.1 FEATURES A 20" OBLONG DRIP PAN TO CONTAIN DRIPPINGS AND GIVES THE OPERATOR A WORKSPACE FOR TOOLS.

JAYCO THIEF HATCHES ARE DESIGNED FOR OPTIMUM PERFORMANCE AND EASY CLEANING AND MAINTENANCE, WITH STANDARD SETTINGS OF 4.0 OUNCE PRESSURE AND 0.4 OUNCE VACUUM WITH OPTIONAL SPRINGS FOR 2, 6, 8, 12, 14, AND 16 OUNCE PRESSURE SETTINGS. JAYCO THIEF HATCHES ALLOWS LESS THAN 1.0 CFH @ 90% OF SET PRESSURE. BASE GASKET STANDARD WITH HATCH.

JT-20.1 SPECIFICATIONS

BASE AND LID SIZE:	NOMINAL 8" ROUND WITH 20" LONG PAN
BOLT PATTERN:	16 HOLES AT 10 3/8" CIRCLE (API) (RECOMMENDED TORQUE 16-18 FT-LBS)
CONSTRUCTION:	ALL ALUMINUM CASTINGS
SYSTEM OPERATIONS:	SPRING LOADED PRESSURE AND VACUUM
STANDARD SETTINGS:	4 OZ. PRESSURE 0.4 OZ. VACUUM
GASKET MATERIAL:	SUPREME65, BLACK VITON® OR BLUE VITON®
BASE GASKET:	INCLUDED

APPROXIMATE SHIPPING WEIGHT: 18 LBS • VITON® IS A REGISTERED TRADEMARK OF DUPONT DOW ELASTOMERS



9412 NICHOLS ROAD • PO BOX 20026 • OKLAHOMA CITY, OK 73156

800-654-9263 • 405-751-6903 • FAX 405-755-7940 • WWW.JAYCO.ORG

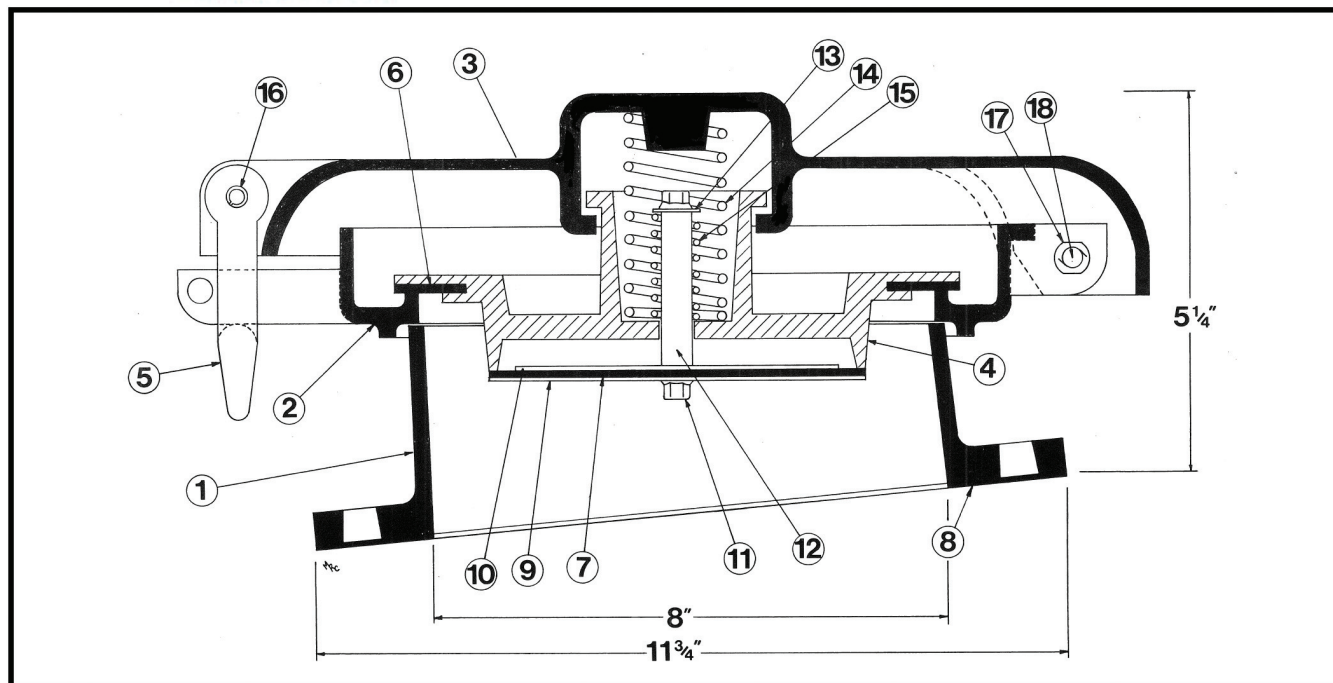

1. BASE (RECOMMENDED TORQUE 16-18 FT-LBS)	JT2035	ALUMINUM
2. LONG PAN	JT2045	ALUMINUM
3. LID	JT2055	ALUMINUM
4. PRESSURE/VACUUM VALVE COMPLETE (INCLUDES **)	JT1818S	ALUMINUM
5. LATCH	JT8205	ALUMINUM
**6 & 7. PRESSURE & VACUUM GASKET SET (JT1815S & JT1820S)	JT1SUPR652P	SUPREME65
PRESSURE & VACUUM SOUR SERV. SET (JT1815V & JT1820V)	JT1VITON2P	VITON®
PRESSURE & VACUUM BLUE WRAP SET (JT1815WV & JT1820WV)	JT1VITONW	VITON®
8. BASE GASKET	JT1810S	SUPREME65
BASE GASKET (SOUR SERVICE)	JT1810V	VITON®
** 9. WASHER (LOWER)	JT0863	ALUMINUM
** 10. WASHER (UPPER)	JT0860	ALUMINUM
** 11. SCREW HHTL 1/4-20 X 3/4	JT0871	STAINLESS
** 12. STEM 1/2 X 2 1/2	JT0850	ALUMINUM
** 13. WASHER 1/4	JT0861	STAINLESS
14. SPRING, PRESSURE (STANDARD 4 oz PLATED)		
4 oz (PLAIN) JT0835	2 oz (BLACK) JT0830	PLATED OR SS
6 oz (YELLOW) JT0837	8 oz (ORANGE) JT0838	STAINLESS
12 oz (WHITE) JT0846	14 oz (GREEN) JT0839	STAINLESS
16 oz (BLUE) JT0847	24 oz (PURPLE) JT0849	STAINLESS
** 15. SPRING, VACUUM	JT0825	STAINLESS
16. LATCH ROLL PIN	JV0130	ZINC PLATED
17. PUSH NUT, 1/4 (USE ONLY ONCE - THEN REPLACE)	JT0887	
18. HINGE PIN (LONG)	JT0885	GALVANIZED
** WASHER, INTERNAL LOCK, BOTTOM	JT0872	STAINLESS
MOUNTING BOLT AND NUT SET (16)	JT-B&N	ZINC PLATED

IN KEEPING WITH, AND FOR THE PURPOSE OF PRODUCT IMPROVEMENT, JAYCO RESERVES THE RIGHT TO MAKE DESIGN CHANGES WITHOUT PRIOR NOTICE.

** PRESSURE/VACUUM VALVE INCLUDES THESE PARTS PLUS MORE UNSHOWN PARTS

BULLETIN NUMBER 1015 23

VITON® IS A REGISTERED TRADEMARK OF DUPONT DOW ELASTOMERS



NEW BLACK TEFLON COATING



THE JAYCO PEAK 1 THIEF HATCH IS DESIGNED WITH OUR NEW BLUE VITON® WRAP-A-ROUND PRESSURE GASKET FOR OUR BEST DURABILITY AND SEALING. THE PEAK 1 COMES COMPLETE WITH VITON® GASKETS AND STAINLESS STEEL PARTS. THE LID, BASE AND INTERNAL PLUNGER ARE TEFLON COATED MAKING THIS HATCH SUITABLE FOR DEMANDING ENVIRONMENTS. JAYCO PEAK 1 THIEF HATCHES ALLOWS LESS THAN 1.0 CFH @ 90% OF SET PRESSURE.

PEAK 1 SPECIFICATIONS

BASE AND LID SIZE:	NOMINAL 8" ROUND
HATCH DESIGN:	JT-8.1
BOLT PATTERN:	16 HOLES AT 10 3/8" CIRCLE (API) (RECOMMENDED TORQUE 16-18 FT-LBS)
CONSTRUCTION:	ALL TEFLON COATED ALUMINUM CASTINGS
SYSTEM OPERATIONS:	SPRING LOADED PRESSURE AND VACUUM
STANDARD SETTINGS:	4 OZ. PRESSURE 0.4 OZ. VACUUM
OPTIONAL PRESSURE SET:	6OZ, 8OZ, 12OZ, 14OZ, AND 16OZ
INTERNAL PARTS:	ALL STAINLESS STEEL
PRESSURE GASKET:	BLUE VITON® WRAP-A-ROUND
VACUUM GASKET:	BLUE VITON® FLAT
BASE GASKET:	BLACK VITON® INCLUDED

APPROXIMATE SHIPPING WEIGHT: 12 LBS • VITON® IS A REGISTERED TRADEMARK OF DUPONT DOW ELASTOMERS

9412 NICHOLS ROAD • PO BOX 20026 • OKLAHOMA CITY, OK 73156

800-654-9263 • 405-751-6903 • FAX 405-755-7940 • WWW.JAYCO.ORG

JAYCO PARTS LIST

JT1818S PLUNGER

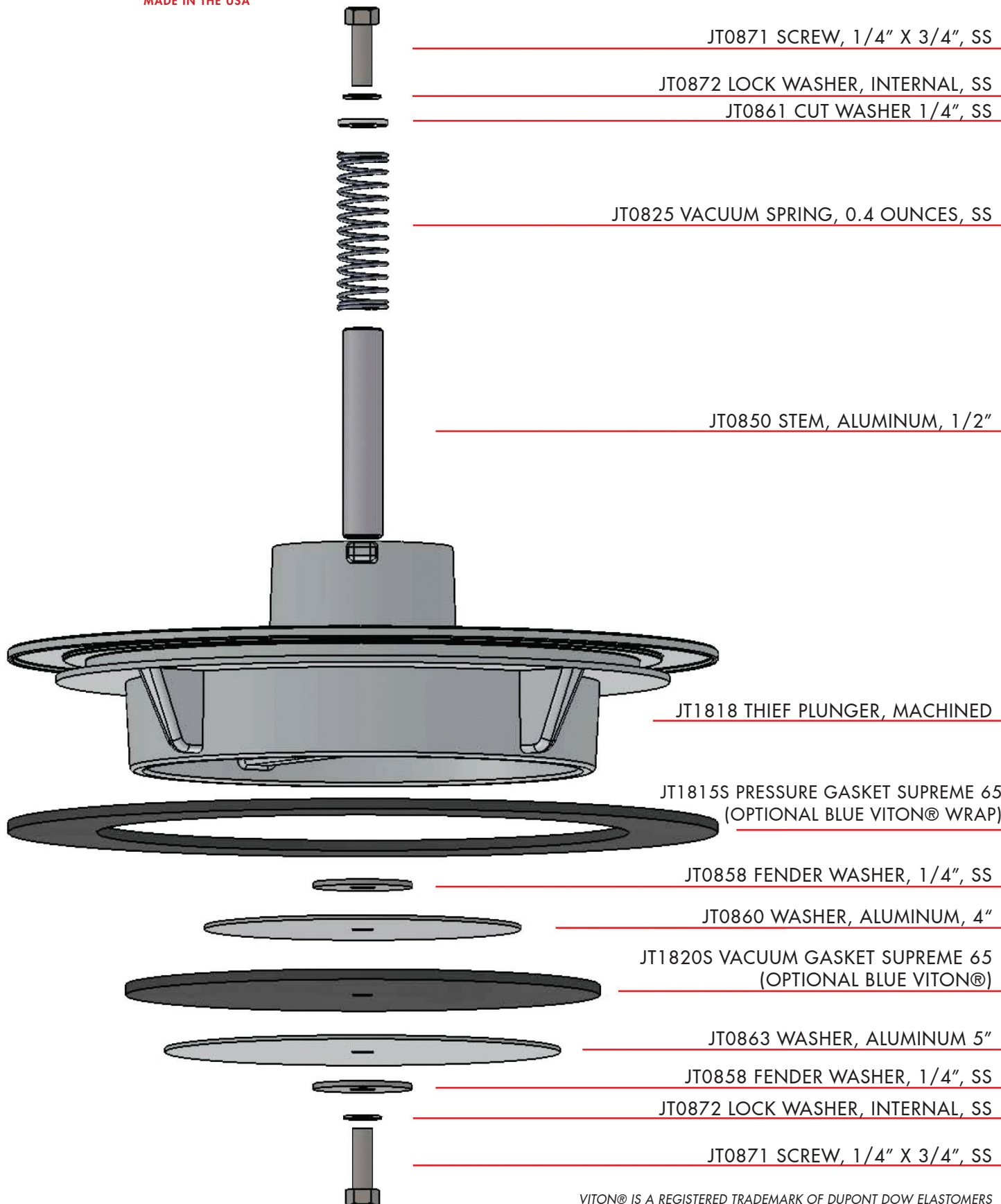

VITON® IS A REGISTERED TRADEMARK OF DUPONT DOW ELASTOMERS

JAYCO THIEF HATCH GASKETS & PLUNGERS

JAYCO THIEF HATCH GASKETS ARE OFFERED IN THREE FLAVORS: SUPREME65, BLACK VITON®, AND BLUE WRAP-A-ROUND VITON®. THESE GASKETS CAN BE ORDERED AS A TWO PIECE SET (PRESSURE AND VACUUM) OR ALREADY INSTALLED ON A NEW STYLE PLUNGER. CUSTOMERS WITH ORIGINAL STYLE PLUNGERS CAN UPGRADE THEIR HATCHES WITH THE NEW STYLE PLUNGER. GASKETS LISTED BELOW ONLY WORK ON JAYCO'S NEW STYLE PLUNGER WITH AUTO CENTERING GUIDES.



SUPREME65

JAYCO SUPREME65 IS A HIGH GRADE OF BUNA NITRILE. THIS IS THE STANDARD GASKET MATERIAL FOR JAYCO THIEF HATCHES AND IS SUITABLE FOR A BROAD ARRAY OF APPLICATIONS. WHEN INSTALLED ON THE NEW STYLE PLUNGER, THESE GASKETS OFFER EXCELLENT SEALING PERFORMANCE.

GASKET SET JT1SUPR65 2P • PLUNGER JT1818S

BLACK VITON®

JAYCO BLACK VITON® IS A FLAT GASKET SIMILAR TO THE SUPREME65 GASKET. VITON® HAS EXCELLENT CHEMICAL RESISTANCE AND IS A MUST HAVE GASKET FOR H2S ENVIRONMENTS. THE SEALING PERFORMANCE IS EXCELLENT. JAYCO BLACK VITON® GASKETS ARE MARKED ON THE SIDE WITH A LIGHT BLUE STRIPE AND ARE TREATED WITH A SWEET CINNAMON SCENT.

GASKET SET JT1VITON 2P • PLUNGER JT1818V



BLUE VITON®

JAYCO BLUE VITON® IS A PREMIUM MOLDED GASKET MATERIAL. THE PRESSURE GASKET WRAPS AROUND THE PLUNGER FOR INCREASED SECURITY. JAYCO BLUE VITON® HAS EXCELLENT CHEMICAL RESISTANCE AND IS A MUST HAVE FOR H2S ENVIRONMENTS. THE SEALING PERFORMANCE IS EXCELLENT. THE BLUE GASKETS COMES STANDARD ON THE PEAK1 THIEF HATCH.

GASKET SET JT1VITON W • PLUNGER JT1818WV

JAYCO THIEF HATCHES COME STANDARD WITH BUNA N GASKETS DESIGNED TO WORK IN NORMAL (SWEET CRUDE) OPERATION OF TANK SYSTEMS IN THE OILFIELD. IF YOUR APPLICATION WILL NOT WORK WITH BUNA N, YOU MUST ORDER THE APPROPRIATE GASKET MATERIAL FOR YOUR SITUATION.

NITRILE SUPREME65

- SERVICE RATING: -40 TO 220 F
- GOOD MECHANICAL & PHYSICAL PROPERTIES
- RESISTANT TO: MOST NON-AROMATIC PETROLEUM-BASED FLUIDS AND GASES, COMPRESSION SET
- UV LIGHT : POOR
- A PREMIUM GRADE OF BUNA N

FLUOROCARBON VITON® FLUOREL®*

- SERVICE RATING: -45 TO 450 F
- RESISTANT TO: ACIDS (EXCELLENT), FUELS AND OIL (EXCELLENT), AROMATIC HYDROCARBONS (EXCELLENT), CHLORINATED SOLVENTS (EXCELLENT), ALCOHOLS (EXCELLENT)
- UV LIGHT (EXCELLENT)
- WEATHERING AND OZONE (EXCELLENT).

RECOMMENDED FOR H2S PRODUCTION.

JAYCO BLUE VITON® GASKETS

JAYCO BLUE VITON® GASKETS

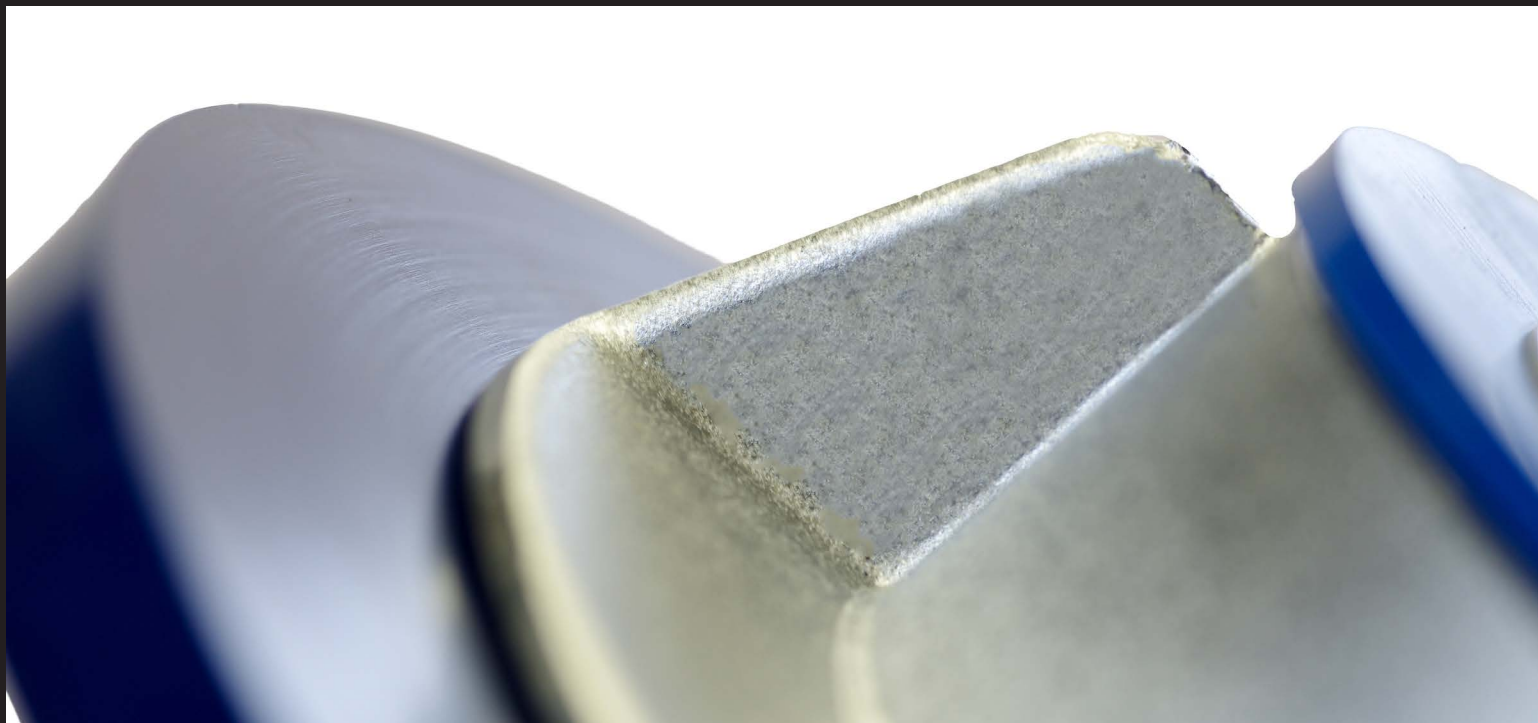

JAYCO BLUE VITON® GASKETS ARE PREMIUM MOLDED GASKETS. THE PRESSURE GASKET WRAPS AROUND THE PLUNGER TO HOLD IN PLACE. THESE ARE EASILY IDENTIFIED AS VITON® BY THEIR RICH BLUE COLOR.

THE OLDER STYLE JT-8 AND JT-20 (PRE OCTOBER 2011 MODEL) MUST BE UPDATED WITH THE NEW STYLE PLUNGER ASSEMBLIES TO USE THE BLUE VITON® WRAP GASKET SETS. SPECIFY P/N JT1818WV WHEN ORDERING.

SERVICE RATING: -45 TO 450F • RECOMMENDED FOR H2S PRODUCTION

THE JAYCO PEAK 1 THIEF HATCH IS DESIGNED WITH OUR NEW BLUE VITON® WRAP-A-ROUND PRESSURE GASKET FOR ENHANCED DURABILITY AND SEALING. THE PEAK 1 COMES COMPLETE WITH VITON® GASKETS AND STAINLESS STEEL PARTS. THE LID, BASE AND INTERNAL PLUNGER ARE TEFLON COATED MAKING THIS HATCH SUITABLE FOR DEMANDING ENVIRONMENTS.



VITON® IS A REGISTERED TRADEMARK OF DUPONT DOW ELASTOMERS

9412 NICHOLS ROAD • PO BOX 20026 • OKLAHOMA CITY, OK 73156

800-654-9263 • 405-751-6903 • FAX 405-755-7940 • WWW.JAYCO.ORG



THE JAYCO NV-8 NON-VENT HATCH PROVIDES A VAPOR TIGHT SEAL WHILE GIVING THE OPERATOR ACCESS TO THE CONTENTS OF THE STORAGE TANK. THIS HATCH DOES NOT ALLOW VENTING TO THE ATMOSPHERE BUT DOES ALLOW GAUGING, SAMPLING AND MEASURING OF LEVELS. BOLT PATTERN COMES IN 16 HOLE API OR 8 HOLE ANSI 150 LB.

OTHER SYSTEMS MUST BE IN PLACE TO HANDLE PRESSURE AND VACUUM PROTECTION FOR THE STORAGE TANK. IF A VENTING HATCH IS DESIRED, REFER TO THE JAYCO THIEF HATCHES FOR VACUUM AND PRESSURE RELIEF.

NV-8 SPECIFICATIONS

BASE AND LID SIZE: NOMINAL 8" ROUND
BOLT PATTERN: 8 HOLE ANSI PATTERN OR
16 HOLE API PATTERN
CONSTRUCTION: ALL ALUMINUM
INTERNAL GASKET: VITON®
BASE GASKET: SUPREME65

APPROXIMATE SHIPPING WEIGHT: 14 LBS
VITON® IS A REGISTERED TRADEMARK OF DUPONT DOW ELASTOMERS



9412 NICHOLS ROAD • PO BOX 20026 • OKLAHOMA CITY, OK 73156

800-654-9263 • 405-751-6903 • FAX 405-755-7940 • WWW.JAYCO.ORG

JAYCO NON-VENT HATCH

NV-8 PARTS LIST

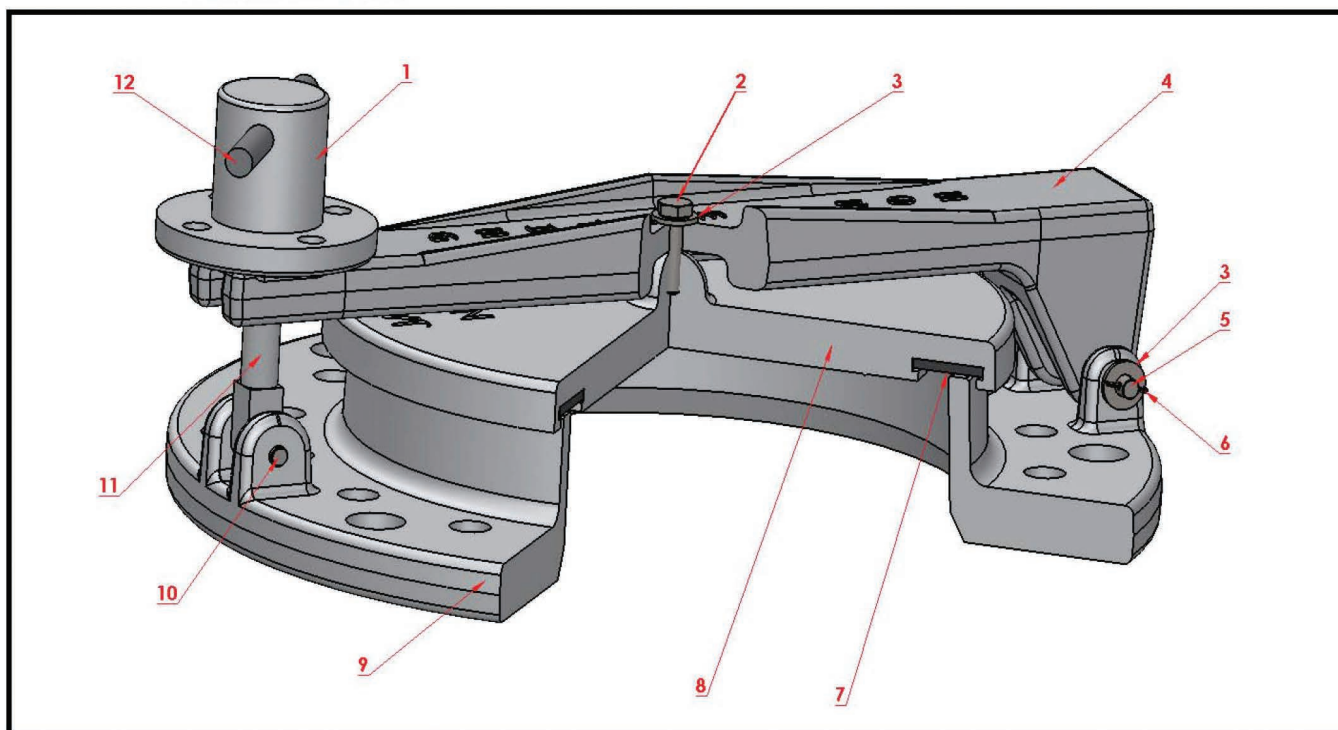

1. HATCH NUT	NV8031	ALUMINUM
2. HEX CAP SCREW 1/4"-20 X 1"	NV0860	STAINLESS
3. 1/4" CUT WASHER	JT0859	STAINLESS
4. ARM	NV8002	ALUMINUM
5. HINGE PIN, 1/4" X 3-1/4"	NV0876	STAINLESS
6. COTTER PIN	JT0869	STAINLESS
7. PRESSURE GASKET	JT1815S	SUPREME65
PRESSURE GASKET (SOUR SERVICE)	JT1815V	VITON®
8. LID	NV8021	ALUMINUM
9. BASE	NV8011	ALUMINUM
10. GROOVE PIN 1/4" X 1-3/4"	NV8055	STAINLESS
11. ALUMINUM EYE BOLT 1/2"-13 X 3"	NV8007	ALUMINUM
12. GROOVE PIN 3/8" X 3-1/2"	NV0850	ZINC PLATED

IN KEEPING WITH, AND FOR THE PURPOSE OF PRODUCT IMPROVEMENT, JAYCO RESERVES THE RIGHT TO MAKE DESIGN CHANGES WITHOUT PRIOR NOTICE.

VITON® IS A REGISTERED TRADEMARK OF DUPONT DOW ELASTOMERS



JAYCO LEVELING SADDLES

LS 1000, LS 1006, & LS 2000



THE PURPOSE OF THE LEVELING SADDLE IS TO PROVIDE A MOUNT FOR A VERTICAL 2" RISER PIPE FROM A HORIZONTAL METER TUBE (PIPE RUN). BECAUSE NOT ALL METER TUBES ARE LEVEL, JAYCO LEVELING SADDLES OFFER AN ADJUSTMENT BOLT TO LEVEL THE RISER PIPE.



LS 1000

- LS 1002 2 INCH U-BOLT KIT W/ SADDLE
- LS 1003 3 INCH U-BOLT KIT W/ SADDLE
- LS 1004 4 INCH U-BOLT KIT W/ SADDLE

2 INCH, 3 INCH & 4 INCH

LS 1006

- LS 1006 6 INCH U-BOLT KIT W/ SADDLE

6 INCH



LS 2000

- LS 2008 8 INCH U-BOLT KIT W/ SADDLE
- LS 2010 10 INCH U-BOLT KIT W/ SADDLE
- LS 2012 12 INCH STRAP W/ SADDLE
- LS 2014 14 INCH STRAP W/ SADDLE
- LS 2016 16 INCH STRAP W/ SADDLE
- LS 2018 18 INCH STRAP W/ SADDLE
- LS 2020 20 INCH STRAP W/ SADDLE
- LS 2024 24 INCH STRAP W/ SADDLE

12 INCH

9412 NICHOLS ROAD • PO BOX 20026 • OKLAHOMA CITY, OK 73156

800-654-9263 • 405-751-6903 • FAX 405-755-7940 • WWW.JAYCO.ORG



THE 9100XT TANK THERMOSTAT IS SPECIFICALLY DESIGNED TO CONTROL THE TEMPERATURE OF HEATERS, TREATERS, AND SEPARATORS WITHIN THE PETROLEUM INDUSTRY. IT IS ENTIRELY SELF-CONTAINED, REQUIRES NO EXTERNAL POWER SOURCE, AND IS THE MOST WIDELY PREFERRED UNIT OF ITS KIND. WHEN INSTALLED IN A TREATER, THE NORMALLY OPEN VALVE WILL AUTOMATICALLY CLOSE OFF THE FLOW OF GAS AS TEMPERATURE INCREASES.

THE TRERICE 9100XT IS RUGGEDLY CONSTRUCTED WITH A HEAVY DUTY, DIE CAST ALUMINUM ACTUATOR HOUSING AND FULLY ENCLOSED BELLOWS ASSEMBLY. ITS SINGLE SEATED, CAST-IRON VALVE BODY IS FITTED WITH A STAINLESS STEEL PLUG ASSEMBLY AND SOFT SEATING VITON O-RINGS TO PROVIDE TIGHT SHUT-OFF.



91000XT SPECIFICATIONS

VALVE SIZE:	3/4"	
RANGE:	110/1900 F OR 80/1400 F	
BULB:	8 INCH	MATERIAL: COPPER
WELL:	8.5 INCH	MATERIAL: CARBON STEEL
CAPILLARY:	10 FOOT	MATERIAL: COPPER
DIRECT ACTING		



WIKA MEASUREMENT PRESSURE GAUGES

213.40 • 2.5" / 4"
LIQUID FILLED UTILITY GAUGES

- CAST BRASS CASE
- ACRYLIC WINDOW
- COPPER ALLOY
- WETTED PARTS
- 1.5% OF SPAN ACCURACY
- 2.5" BRASS PLATED ABS RING
- 4" CHROME PLATED BRASS RING
- GLYCERIN LIQUID FILLING



111.10 • 1.5" / 2" / 2.5" / 4"
DRY COMMERCIAL GAUGES

- BLACK ABS CASE
- SNAP-IN ACRYLIC WINDOW
- COPPER ALLOY WETTED PARTS
- 3/2/3% ACCURACY

233.34 • 4.5" / 6"
PROCESS GAUGES

- FIBERGLASS REINFORCED THERMOPLASTIC CASE

- ACRYLIC WINDOW
- 316 SS WETTED PARTS
- 0.5% OF SPAN ACCURACY



111.12 • 1.5" / 2" / 2.5"
DRY COMMERCIAL GAUGES

- BLACK ABS CASE
- SNAP-IN ACRYLIC WINDOW

- COPPER ALLOY WETTED PARTS
- 3/2/3% ACCURACY

332.54 • 4"
INSPECTOR'S TEST GAUGE

- STAINLESS STEEL CASE
- SAFETY GLASS WINDOW

- 316 SS WETTED PARTS 1/4" CONN.
- 0.25% OF SPAN ACCURACY



9412 NICHOLS ROAD • PO BOX 20026 • OKLAHOMA CITY, OK 73156

800-654-9263 • 405-751-6903 • FAX 405-755-7940 • WWW.JAYCO.ORG



213.53 • 2.5" / 4" LIQUID FILLED UTILITY GAUGES

- STAINLESS STEEL CASE POLYCARBONATE
- COPPER ALLOY WETTED PARTS
- 1.5% OF SPAN ACCURACY
- GLYCERIN LIQUID FILLING

312.20 • 6" TEST GAUGE

- STAINLESS STEEL CASE
- LAMINATED SAFETY GLASS WINDOW
- COPPER ALLOY WETTED PARTS

- 0.25% OF SPAN ACCURACY
- DIAL WITH MIRRORED BAND
- KNIFE-EDGE POINTER



233.54 • 2.5" / 4" ALL STAINLESS STEEL GAUGES

- 304 SS CASE
- SAFETY GLASS WINDOW
- 316 SS WETTED PARTS

- 1.0% OF SPAN ACCURACY
- GLYCERIN LIQUID FILLING

700.04 • 2.5" / 4" DIFFERENTIAL GAUGES

- BLACK THERMOPLASTIC
- ACRYLIC WINDOW
- CERAMIC MAGNET

- 316 SS SPRING
- VITON O-RING
- 2% ACCURACY



611.10 • 2.5" LOW PRESSURE GAUGES

- BLACK PAINTED STEEL CASE
- ACRYLIC WINDOW

- COPPER ALLOY WETTED PARTS
- 1.5% OF SPAN ACCURACY

ELECTRONIC MEASUREMENT

- S-10 GENERAL PURPOSE TRANSMITTER
- C-10 COMPACT TRANSMITTER
- E-10 EXPLOSION-PROOF TRANSMITTER
- DG-10 DIGITAL PRESSURE GAUGE



9412 NICHOLS ROAD • PO BOX 20026 • OKLAHOMA CITY, OK 73156

800-654-9263 • 405-751-6903 • FAX 405-755-7940 • WWW.JAYCO.ORG



- HERMETIC SEAL
- TAMPER-PROOF (W/O RESET SCREW)
- 1 % FULL SPAN ACCURACY

- STAINLESS STEEL CASE
- HEAVY DUTY GLASS LENS

MODEL TI.33

THERMOWELLS MUST BE USED ON ALL PRESSURE OR VELOCITY APPLICATIONS, TO PROTECT THE STEM OF THE THERMOMETER FROM CORROSION AND PHYSICAL DAMAGE, AND TO FACILITATE REMOVAL OF THE THERMOMETER WITHOUT DISTURBING THE PROCESS.

STEM LENGTHS

[025]	[040]	[060]	[090]
2.5"	4.0"	6.0"	9.0"

TEMPERATURE RANGES

0/250°F	-40/120°F	50/550°F	200/1000°F*
---------	-----------	----------	-------------



MAXIMUM AMBIENT TEMPERATURE 200° F • * MINIMUM STEM LENGTH FOR THIS RANGE IS 4"

9412 NICHOLS ROAD • PO BOX 20026 • OKLAHOMA CITY, OK 73156

800-654-9263 • 405-751-6903 • FAX 405-755-7940 • WWW.JAYCO.ORG

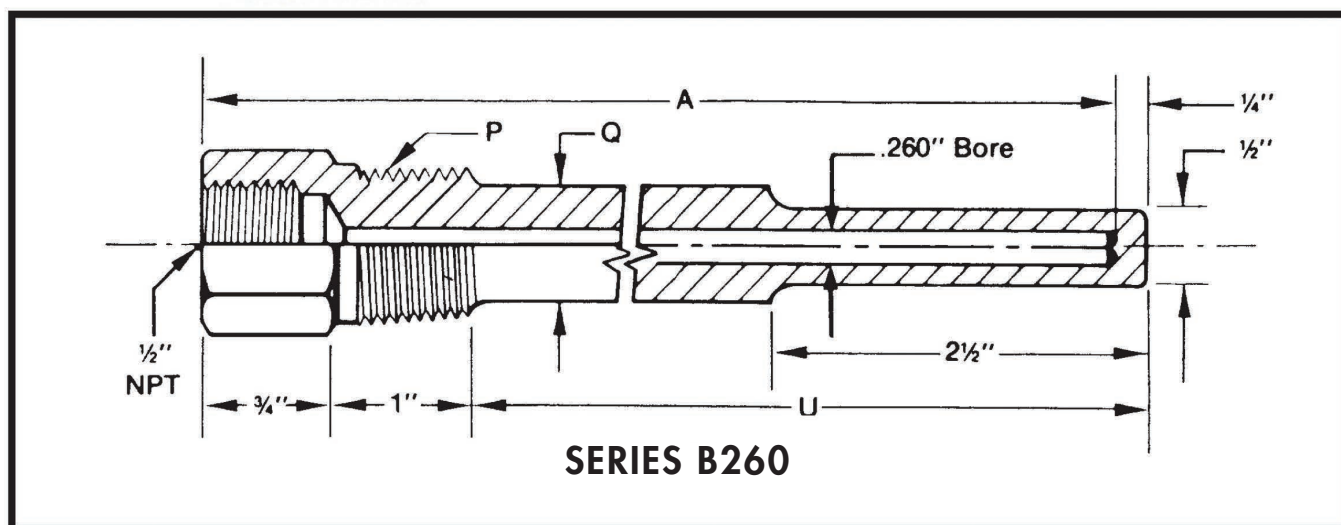

NOMINAL STEM LENGTH "A"	SOCKET INSERTION LENGTH "U"	CARBON STEEL	304 STAINLESS STEEL	316 STAINLESS STEEL
2.5"	1.0 - 1.5"	STOCK	STOCK	SPECIAL ORDER
4.0"	2.5"	STOCK	STOCK	SPECIAL ORDER
6.0"	4.5"	STOCK	STOCK	SPECIAL ORDER
9.0"	7.5"	STOCK	STOCK	SPECIAL ORDER
12.0"	10.5"	SPECIAL ORDER	SPECIAL ORDER	SPECIAL ORDER
EXTERNAL PROCESS THREAD "P"				
1/2" NPT		SPECIAL ORDER	STOCK	
3/4" NPT		STOCK	STOCK	

THERMOWELLS MUST BE USED ON ALL PRESSURE OR VELOCITY APPLICATIONS, TO PROTECT THE STEM OF THE THERMOMETER FROM CORROSION AND PHYSICAL DAMAGE, AND TO FACILITATE REMOVAL OF THE THERMOMETER WITHOUT DISTURBING THE PROCESS.

ALL THERMOWELLS ARE DEEP HOLE DRILLED FROM SOLID BAR STOCK.



3/4" x 3 3/4"	OL 304SS U2	0.718 BORE	2" INSERTION LENGTH
3/4" x 4 3/4"	OL 304SS U3	0.718 BORE	3" INSERTION LENGTH
3/4" x 5 3/4"	OL 304SS U4	0.718 BORE	4" INSERTION LENGTH
3/4" x 7 3/4"	OL 304SS U6	0.718 BORE	6" INSERTION LENGTH

**METER RUN
THERMOWELLS**